

HDA-T/-TF/-TR	t _{fix} min - max [mm]	d _f [mm]	h _s	SW [mm]	T _{inst}
M16 × 190/40	15 - 40	32	2 - 8 mm (1/16" - 5/16")	24	120 Nm (89 ft-lb)
M16 × 190/60	15 - 60	32			

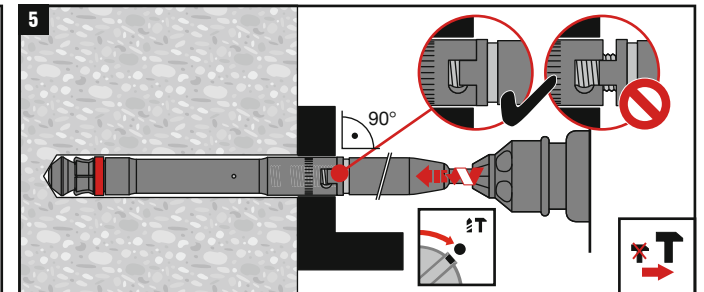

HDA-T/-TF/-TR			
M16 × 190/40	TE-Y-HDA-B 30 × 230	TE-Y-HDA-ST 30-M16	TE 60 - (04)
M16 × 190/60	TE-Y-HDA-B 30 × 250		TE 70 - (03)* TE 70 - (04)*

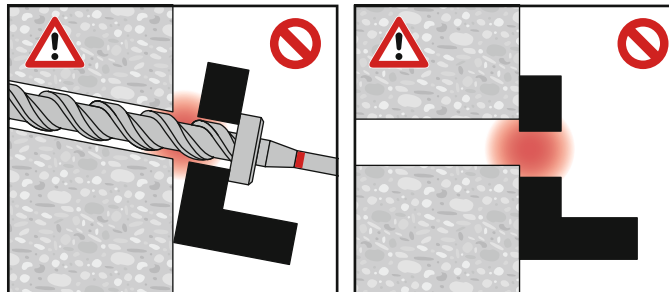
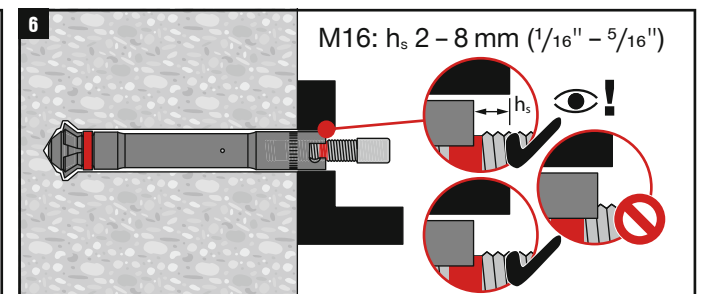
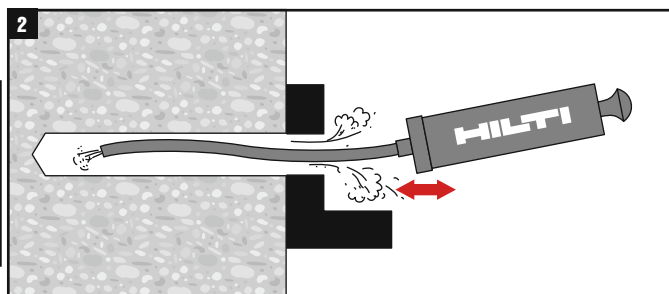

*With TE 70:
 $h_{min} = 340 \text{ mm} - t_{fix}$
 for $t_{fix,max} = 40 \text{ mm}$ and
 $h_{min} = 360 \text{ mm} - t_{fix}$
 for $t_{fix,max} = 60 \text{ mm}$

